



Flex

The Flex custom office chair is undoubtedly one of ADI's greatest successes. Not only the Flex collection offers modularity, but it is also combined with an incredible comfort. All the possible options are present in this collection, allowing to build custom chairs to meet all the needs of the work environment.

MULTITASKING



- ERGONOMIC** ✓
- EXECUTIVE** ✓
- CONFERENCE ROOM** ✓
- MULTI-PURPOSE** ✓
- LOUNGE AND** ✓
- WAITING ROOM** ✓
- INTENSIVE USE** ✓
- BARIATRIC**

TECHNICAL SPECIFICATIONS

- 4 models offered in 4 backrest heights, with the following configurations :
 - 4 ergonomic including 2 available in stool version with footring
- Seat and backrest made of steel tubing with high resilience moulded and cut foam, upholstered using the Suspension technique
- Black nylon resin or polished aluminum star base with casters equipped with a dust protector
- Options include 4 seat sizes, seat slider, inflatable lumbar support, ratchet backrest, etc.
- 9 types of mechanisms with choice of gas lifts offering an extended range of seat height adjustment
- Wide choice of fixed and adjustable armrest models



FX-L
 A : 19"
 C : 17" - 22"
 E : 16"



FX-H
 A : 19"
 C : 17" - 22"
 E : 21"



FX-D
 A : 19"
 C : 17" - 22"
 E : 27"

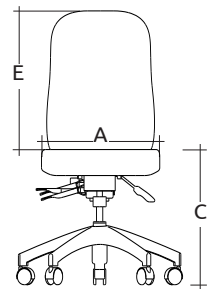

FX-E
 A : 19"
 C : 17" - 22"
 E : 31"



3450, 1re Rue
 St-Hubert (Québec) J3Y 8Y5 Canada
 T 450.926.1004 / 800.663.6794
 F 450.926.0013

adi-artdesign.com

ADI
 ART DESIGN INTERNATIONAL